

**WILD  
STONE**

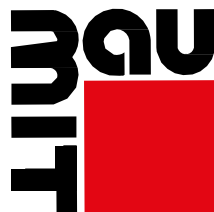

www.wildstone  
.eu  
www.baumit.cz

Baumit system with decorative WILD STONE  
Construction technical certificate no. 020 - 038768.

Issued by the Technický a zkušební ústav stavební Praha s.p. (Technical and Testing Institute of Civil Engineering in Prague)

Authorized person 204 according to the decision of ÚNMZ no. 5/2017.

Branch 0200 - České Budějovice

## DETAIL OF BASIC COMPOSITION - VERTICAL SECTION

### Gluing composition:

- ❶ Masonry
- ❷ Gluing matter:  
Baumit StarContact
- ❸ Insulation product:  
Expanded polystyrene boards:  
EPS 120F façade  
EPS 100F façade
- ❹ Base layer material:  
Baumit StarContact
- ❺ Glass mesh:  
Baumit KeraTex – Vertex R 275  
A101
- ❻ Dowels:  
dowels with a metal pike:  
Ejothem STR U 2G/fischer  
Termoz CS 8
- ❼ Tile gluing matter:  
WILD STONE LM
- ❽ Lightweight stone cladding  
WILD STONE (entire portfolio)
- ❾ Grout:  
WILD STONE SH
- ❿ Hydrophobic spray STONESIL

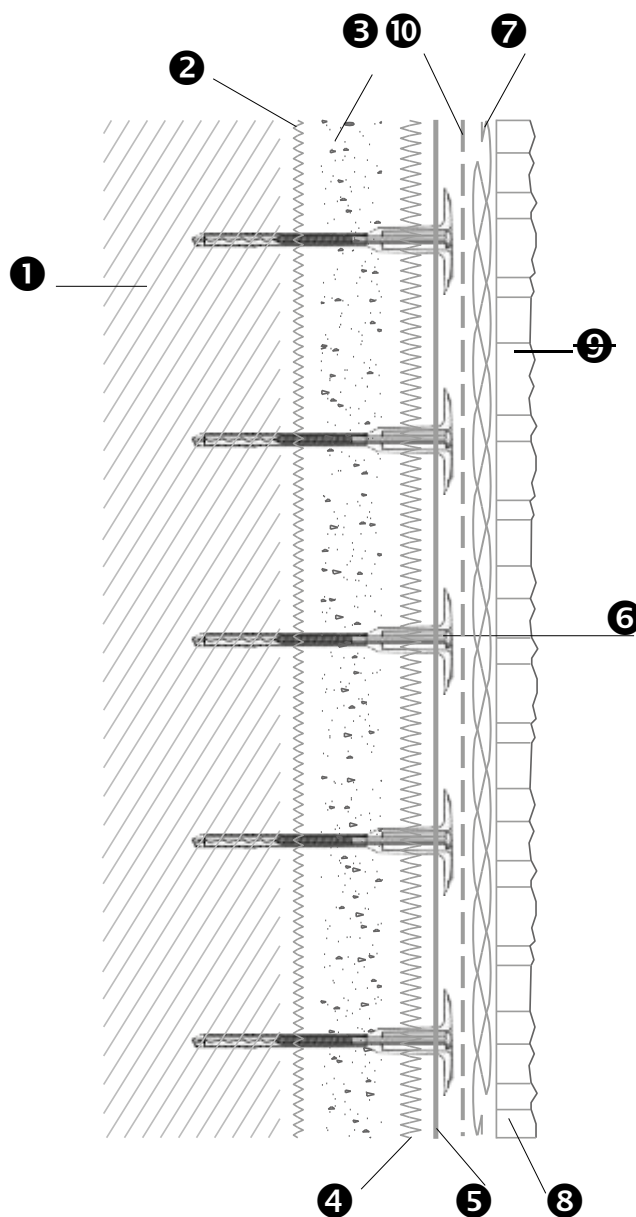

WS contact details:

**WILD STONE international s.r.o.**, Podhořská 806/31, 180 00 Prague 8

ID: 267 23 174 • Tax ID: CZ267 23 174

Facility:

Politických vězňů 1986, 274 01 Slaný, tel.: +420 312 520 159, fax: +420 312 523 104, e-mail: info@wildstone.eu