

Weber system with decorative WILD STONE
Construction technical certificate no. 020 - 036734.
Issued by the Technický a zkušební ústav stavební České Budějovice.
(Technical and Testing Institute of Civil Engineering in Prague)
Authorized person 204 according to the decision of ÚNMZ no. 5/2017.
Branch 0200 - České Budějovice

DETAIL OF BASIC COMPOSITION - VERTICAL SECTION

Gluing composition:

- ❶ Masonry
- ❷ Gluing matter:
Weber.therm elastic LZS 720 (Z), LZS 730
- ❸ Insulation product:
Mineral wool boards: MW (TR80) boards with
perpendicular fiber orientation - lamella)
- ❹ Base layer material:
Weber.therm elastic LZS 720
- ❺ Glass mesh:
2x VERTEX R 131 A101 (two layers) (160 g/m²)
2x weber.therm 131 (two layers)
1x VERTEX R 267 A101 (one layer) (314 g/m²)
- ❻ Dowels:
BRAVOLL PTH-S/EJOTHERM STR U/
EJOTHERM STR U 2G/KOELNER TFIX-8S
- ❼ Tile gluing matter:
WILD STONE LM (W)/weber.xerm862
- ❽ Lightweight stone cladding
WILD STONE (entire portfolio)
- ❾ Grout:
WILD STONE SH
- ❿ Hydrophobic spray STONESIL AGUA

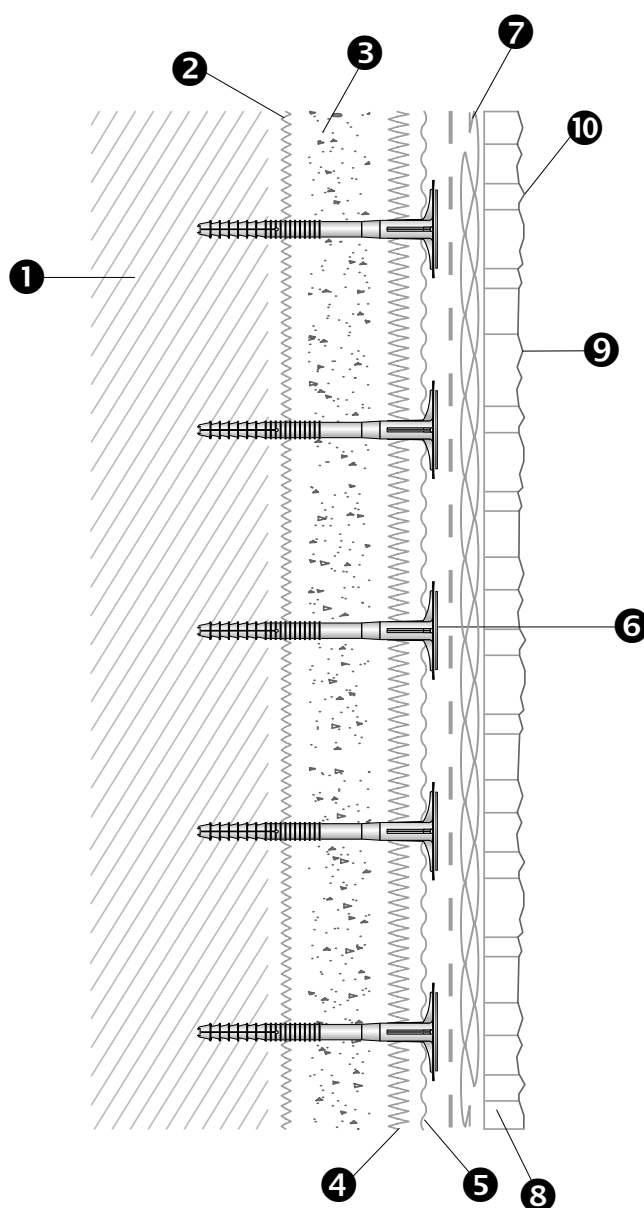

WS contact details:

WILD STONE international s.r.o., Podhořská 806/31, 180 00 Praha 8

ID: 267 23 174 • Tax ID: CZ267 23 174

Facility:

Politických vězňů 1986, 274 01 Slaný, tel.: +420 312 520 159, fax: +420 312 523 104, e-mail: info@wildstone.eu